

DETAIL A

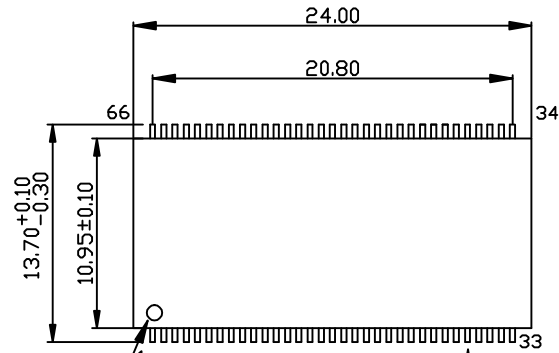
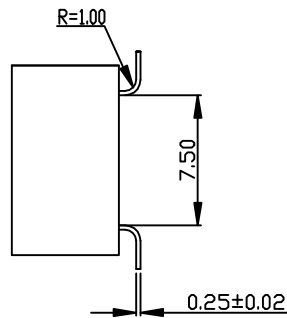
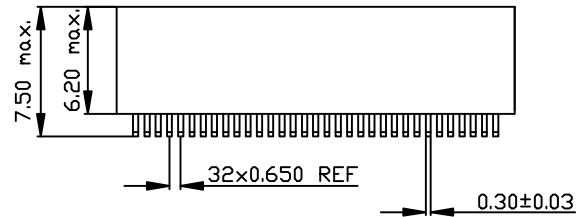

Pin 1 Indicator

DETAIL A

**NOTE: Dimensions in Millimeters**  
**PACKAGE Y4 = 4 LEVEL**  
**CONNECTIC = TSOP ( 66PIN)**  
**PITCH = 0.65**

COTES en millimètres (DIMENSIONS in millimeters)		TOLERANCES GENERALES (GENERAL TOLERANCE)			Modified following DM3300-1214-1		
Testable in Socket : ENPLAS OTS-66.065.11a Modified by 3D PLUS		±0.20mm Unless Otherwise Specified			30/06/05	ST	2
Leads Coplanarity : 0.15mm		DESSINE PAR (DRAWN BY) N M (NAME) S TEVERIN			07/01/2005	First issue	
MATERIE BROCHES (LEADS MATERIAL) KOVAR Thickness : 250µm±20µm		VERIFIE PAR (CHECKED BY) R. BOGAGE			07/01/2005	15/03/05	
FINITION BROCHES (LEADS FINITION) Ni electrolytique (305µm) + Au electrolytique (1.27 Typ. - Soit 182µm)		APPROUVE PAR (APPROVED BY) P MAURICE			07/01/2005	DATE VISA IND	
		ECHELLE (SCALE) NONE			Module :		
		FORMAT (SIZE) A3			Fonction :		
		Mechanical Drawing Module			P.C.B. :		
		SOP 66-065 - Package Y4			Document : 3200-1851		
					PLANCHE (SHEET) 1/1		

A B C D E F G H J K L M N P

1  
2  
3  
4  
5  
6  
7  
8